



Let's start

Let's start



Contents

1. Getting started/STM32MP1 boards/STM32MP157x-EV1/Let's start	3
2. Getting started/STM32MP1 boards/STM32MP157x-EV1/Let's start/Execute basic commands	3
3. Getting started/STM32MP1 boards/STM32MP157x-EV1/Let's start/Populate the target and boot the image	3
4. Getting started/STM32MP1 boards/STM32MP157x-EV1/Let's start/Unpack the STM32MP157x-EV1 board	3
5. Getting started/STM32MP1 boards/STM32MP157x-EV1/Let's start/Use the demo launcher	3



Stable: 15.06.2021 - 15:24 / Revision: 29.04.2021 - 12:11

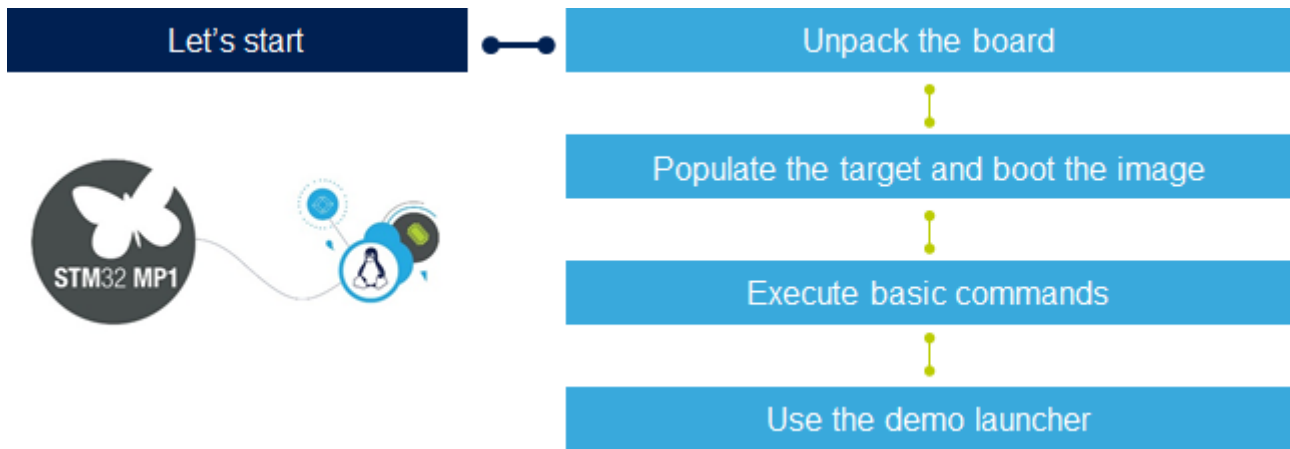

This module explains the basic steps to control your STM32MP157x-EV1 board.



To complete this module, it is assumed a Linux[®] PC running under Ubuntu[®] 18.04 or 20.04 is used.

Refer to [PC_prerequisites](#)

Back

Overview

Next

Linux[®] is a registered trademark of Linus Torvalds.

Stable: 15.06.2021 - 15:24 / Revision: 29.04.2021 - 12:11

Invalid target: no reviewed revision corresponds to the given ID.

[Return to Getting started/STM32MP1 boards/STM32MP157x-EV1/Let's start/Execute basic commands.](#)

Stable: 15.06.2021 - 15:19 / Revision: 29.04.2021 - 11:42

Invalid target: no reviewed revision corresponds to the given ID.

[Return to Getting started/STM32MP1 boards/STM32MP157x-EV1/Let's start/Populate the target and boot the image.](#)

Stable: 15.06.2021 - 15:17 / Revision: 29.04.2021 - 08:59

Invalid target: no reviewed revision corresponds to the given ID.

[Return to Getting started/STM32MP1 boards/STM32MP157x-EV1/Let's start/Unpack the STM32MP157x-EV1 board.](#)

Stable: 05.07.2021 - 13:22 / Revision: 19.04.2021 - 09:55

Invalid target: no reviewed revision corresponds to the given ID.

[Return to Getting started/STM32MP1 boards/STM32MP157x-EV1/Let's start/Use the demo launcher.](#)