



Let's start

Let's start



Contents

1. Getting started/STM32MP1 boards/STM32MP157x-EV1/Let's start	3
2. PC prerequisites	3



STMicroelectronics | Training | STM32MP157x EV1 | 2021 | 0000

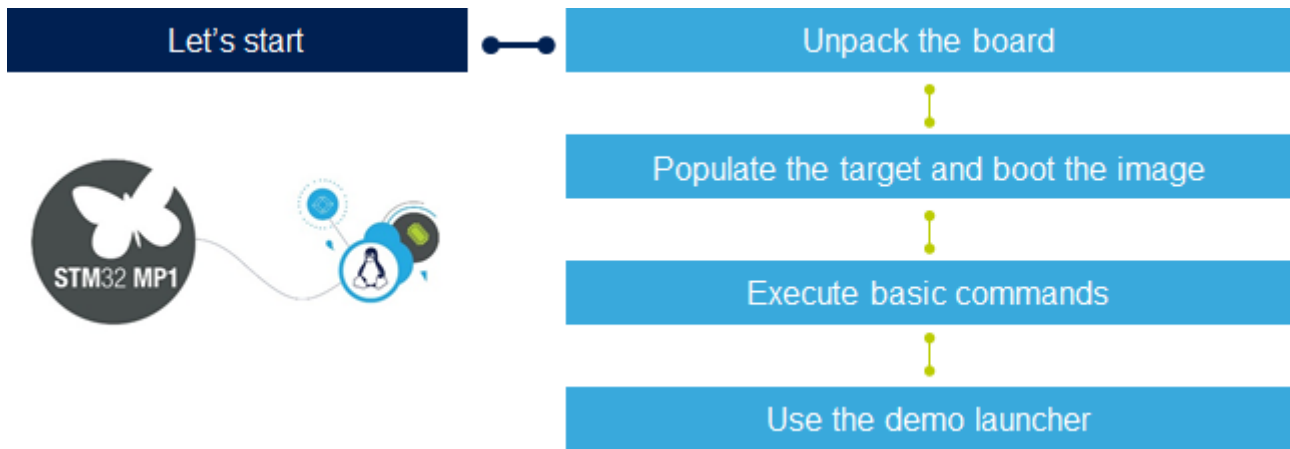

This module explains the basic steps to control your STM32MP157x-EV1 board.



To complete this module, it is assumed a Linux[®] PC running under Ubuntu[®] 18.04 or 20.04 is used.

Refer to [PC_prerequisites](#)

Back

Overview

Next

Linux[®] is a registered trademark of Linus Torvalds.

Stable: 05.07.2021 - 14:55 / Revision: 05.07.2021 - 14:55

Invalid target: no reviewed revision corresponds to the given ID.

[Return to PC prerequisites.](#)