

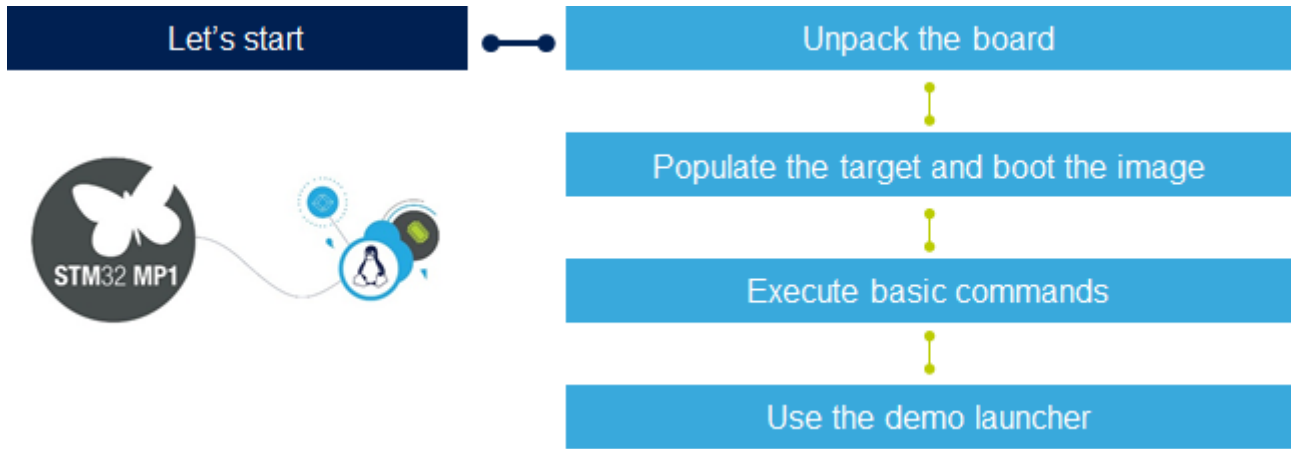



Let's start

Let's start



This module explains the basic steps to control your STM32MP157x-EV1 board.

 To complete this module, it is assumed a Linux[®] PC running under Ubuntu[®] 18.04 or 20.04 is used.
Refer to [PC_prerequisites](#)

[Back](#) [Overview](#) [Next](#)

Linux[®] is a registered trademark of Linus Torvalds.