



Let's start

Let's start



Contents

1. Getting started/STM32MP1 boards/STM32MP157x-EV1/Let's start	3
2. PC prerequisites	3

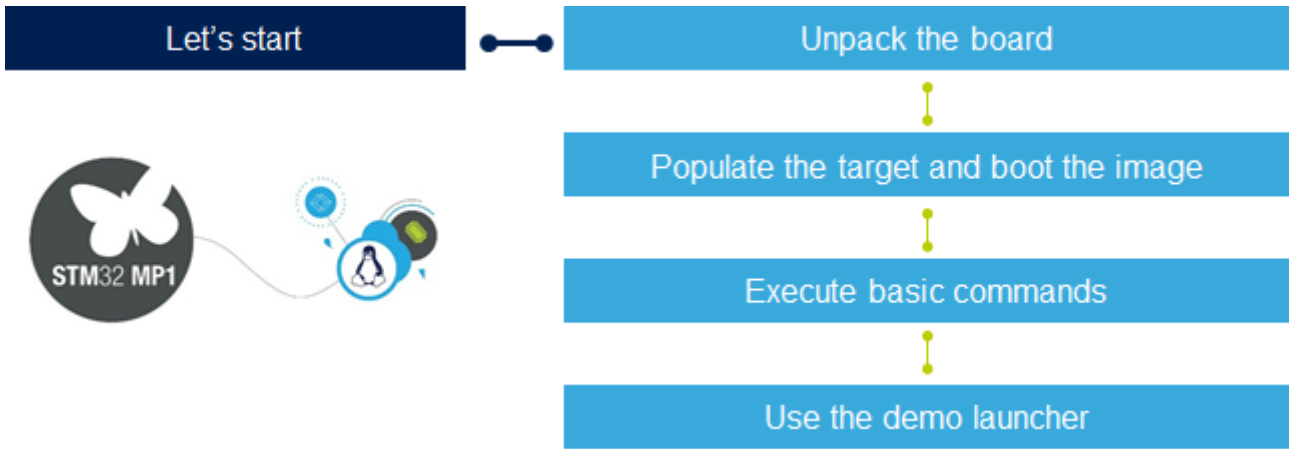

This module explains the basic steps to take control of your STM32MP157x-EV1 board.



To complete this module, it is assumed a Linux PC running on Ubuntu 18.04 or 20.04.
Refer to [PC_prerequisites](#)

Back
Overview
Next

Linux® is a registered trademark of Linus Torvalds.
Stable: 20.05.2021 - 09:33 / Revision: 20.05.2021 - 09:33

Invalid target: no reviewed revision corresponds to the given ID.

[Return to PC prerequisites.](#)