



Let's start

---

Let's start



---

## Contents

---

1. Getting started/STM32MP1 boards/STM32MP157x-EV1/Let's start .....	3
2. Getting started/STM32MP1 boards/STM32MP157x-EV1/Let's start/Execute basic commands .....	3
3. Getting started/STM32MP1 boards/STM32MP157x-EV1/Let's start/Populate the target and boot the image .....	4
4. Getting started/STM32MP1 boards/STM32MP157x-EV1/Let's start/Unpack the STM32MP157x-EV1 board .....	4
5. Getting started/STM32MP1 boards/STM32MP157x-EV1/Let's start/Use the demo launcher .....	5



A quality version of this page, approved on 20 February 2019, was based off this revision.

Template:ArticleMainWriter

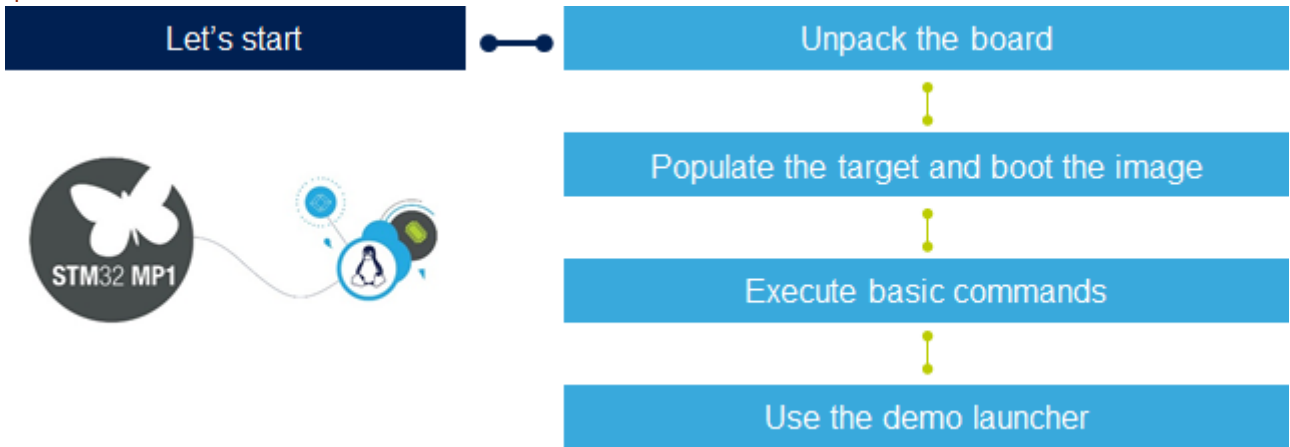

This module explains the basic steps to take control of your STM32MP157x-EV1 board.

 To complete this module, it is assumed a Linux PC running Ubuntu 16.04 is used.

Back
Overview
Next

Linux<sup>®</sup> is a registered trademark of Linus Torvalds.  
Stable: 16.06.2021 - 16.24 / Revision: 29.04.2021 - 12:11

Template:ArticleMainWriter

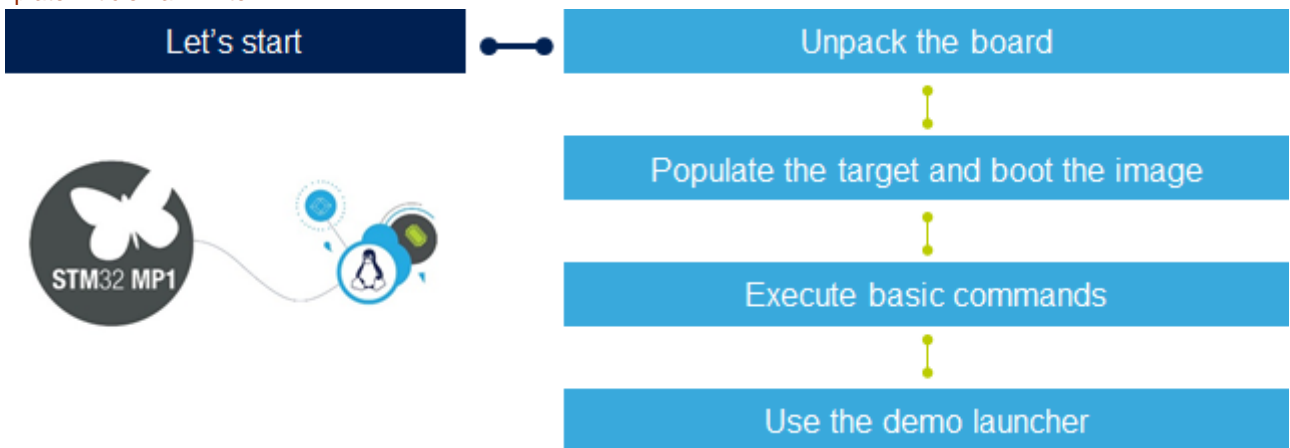

This module explains the basic steps to take control of your STM32MP157x-EV1 board.

 To complete this module, it is assumed a Linux PC running Ubuntu 16.04 is used.



[Back](#)
[Overview](#)
[Next](#)

Linux® is a registered trademark of Linus Torvalds.  
Stable: 15.06.2021 - 15:19 / Revision: 29.04.2021 - 11:42

Template:ArticleMainWriter

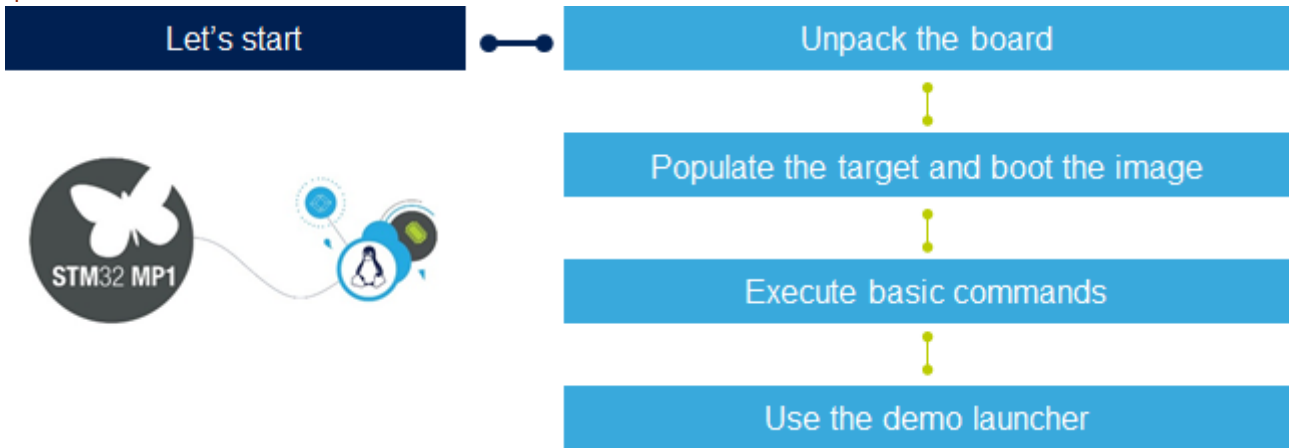

This module explains the basic steps to take control of your STM32MP157x-EV1 board.

**i** To complete this module, it is assumed a Linux PC running Ubuntu 16.04 is used.

[Back](#)
[Overview](#)
[Next](#)

Linux® is a registered trademark of Linus Torvalds.  
Stable: 15.06.2021 - 15:17 / Revision: 29.04.2021 - 08:59

Template:ArticleMainWriter

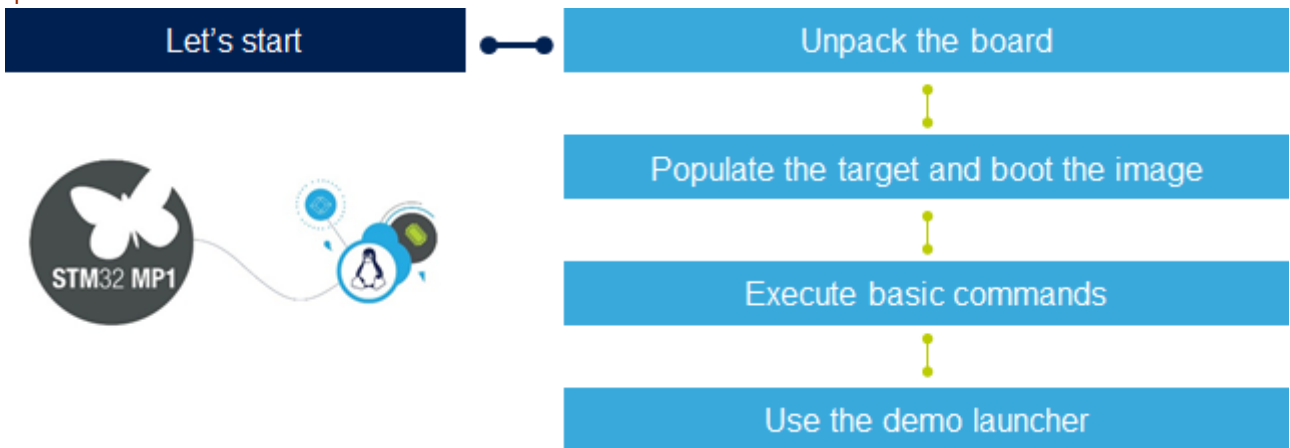



This module explains the basic steps to take control of your STM32MP157x-EV1 board.

 To complete this module, it is assumed a Linux PC running Ubuntu 16.04 is used.

Back
Overview
Next

Linux® is a registered trademark of Linus Torvalds.  
Stable: 06.07.2021 - 13:22 / Revision: 19.04.2021 - 09:55

Template:ArticleMainWriter

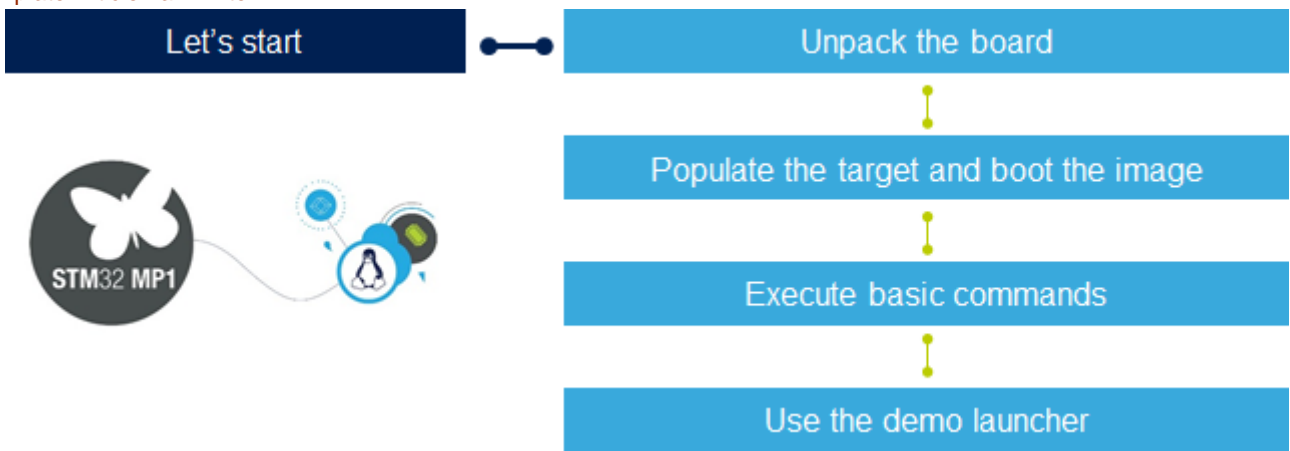

This module explains the basic steps to take control of your STM32MP157x-EV1 board.

 To complete this module, it is assumed a Linux PC running Ubuntu 16.04 is used.

Back
Overview
Next

Linux® is a registered trademark of Linus Torvalds.