



Let's start

---

Let's start



A quality version of this page, approved on 20 February 2019, was based off this revision.

Template:ArticleMainWriter

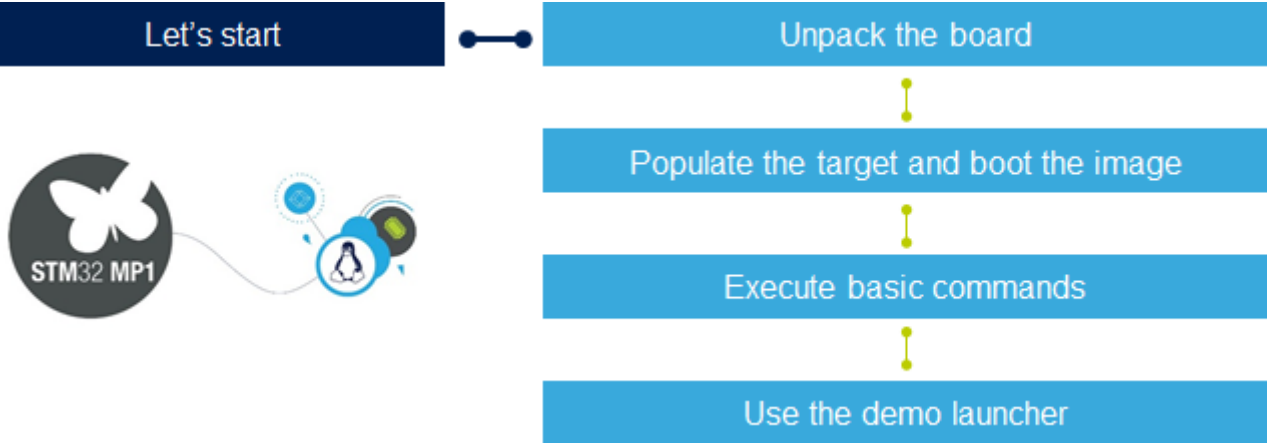

This module explains the basic steps to take control of your STM32MP157x-EV1 board.



To complete this module, it is assumed a Linux PC running Ubuntu 16.04 is used.

[Back](#)

[Overview](#)

[Next](#)

Linux® is a registered trademark of Linus Torvalds.