



Develop on Arm® Cortex®-M4



1.1.2.3 Develop on Arm® Cortex®-M4

Stable: 08.10.2019 - 10:04 / Revision: 08.10.2019 - 10:03

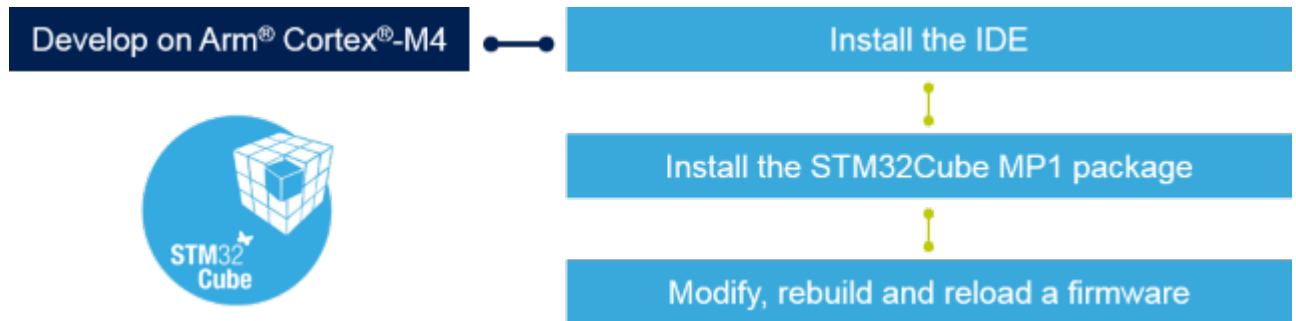

This module guides you to install the STM32MP1 Developer Package to develop on Arm® Cortex®-M4 side. The STM32MP1 Developer Package contains (for the Arm® Cortex®-M4 side) the STM32Cube MPU Package containing all pieces of software (BSP, HAL, middlewares and applications) in source code.

[Back](#)

[Overview](#)

[Next](#)

Microprocessor Unit

Board support package

Hardware Abstraction Layer