



Category:STM32MP157x-EV1

Category:STM32MP157x-EV1



Contents

| | |
|--|---|
| 1. Category:STM32MP157x-EV1 | 3 |
| 2. Getting started/STM32MP1 boards/STM32MP157x-EV1 | 5 |



A quality version of this page, approved on *17 June 2020*, was based off this revision.

This category groups together all articles and subcategories related to the getting started with STM32MP157x-EV1 Evaluation boards.



Subcategories

This category has the following 4 subcategories, out of 4 total.

- STM32MP157x-EV1 - Let's start (5 P)
- STM32MP157x-EV1 - develop on A7 (4 P)
- STM32MP157x-EV1 - develop on M4 (4 P)
- STM32MP157x-EV1 - What's next (1 P)

Pages in category "STM32MP157x-EV1"

This category contains only the following page.

- [Getting started/STM32MP1 boards/STM32MP157x-EV1](#)
Stable: 07.09.2020 - 13:41 / Revision: 07.09.2020 - 13:38

A quality version of this page, approved on 7 September 2020, was based off this revision.

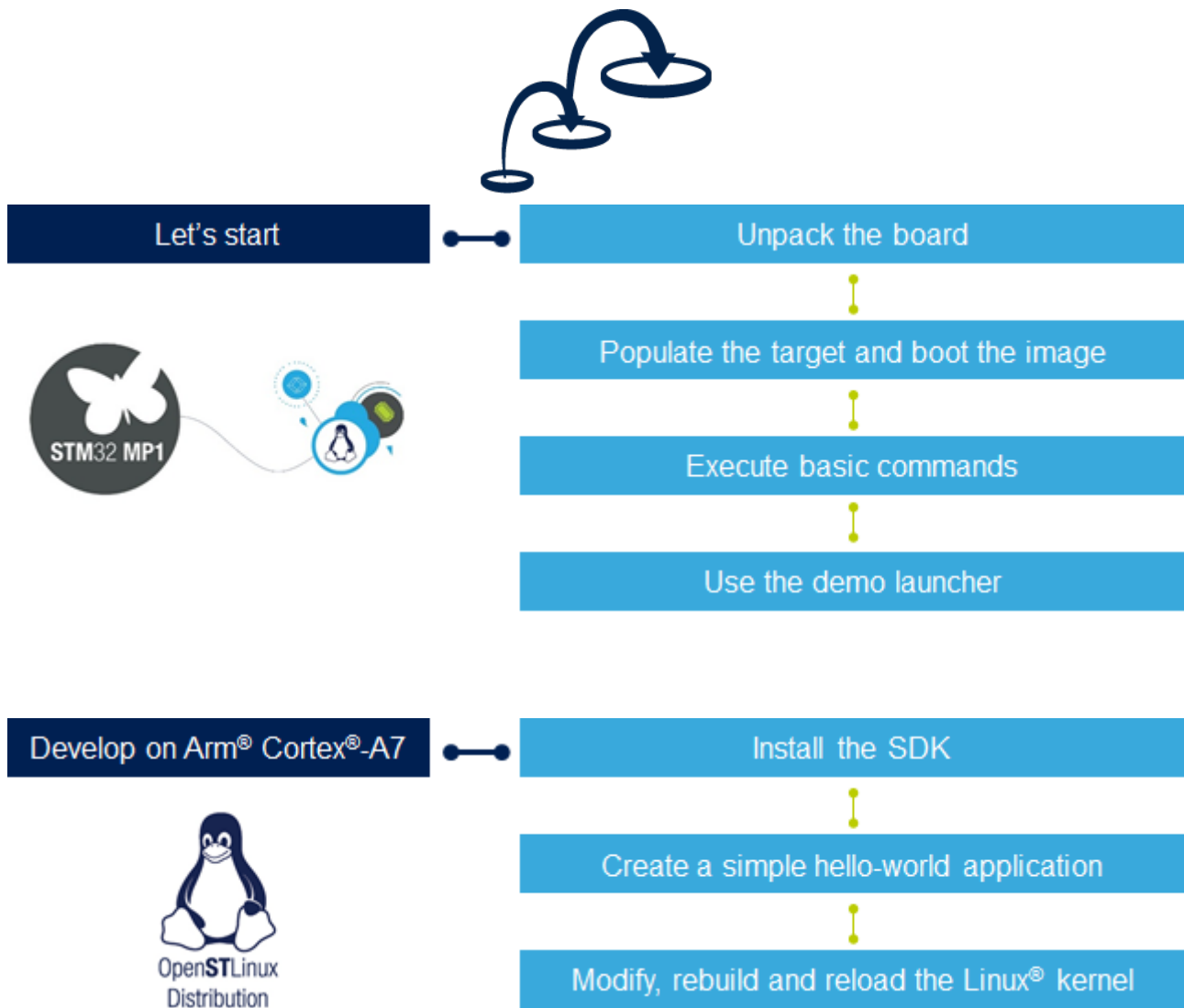



Develop on Arm® Cortex®-M4



Install the IDE

Install the STM32Cube MP1 package

Modify, rebuild and reload a firmware

What's next: Distribution Package and Wiki Development Zone

