



Category:STM32MP157x-DK2

---

Category:STM32MP157x-DK2



---

## Contents

---

1. Category:STM32MP157x-DK2 .....	3
2. Getting started/STM32MP1 boards/STM32MP157x-DK2 .....	5



---

A quality version of this page, approved on *17 June 2020*, was based off this revision.

This category groups together all articles and subcategories related to the getting started with STM32MP157x-DK2 Discovery kits.



---

## Subcategories

---

This category has the following 4 subcategories, out of 4 total.

- STM32MP157x-DK2 - let's start (5 P)
- STM32MP157x-DK2 - develop on A7 (4 P)
- STM32MP157x-DK2 - develop on M4 (4 P)
- STM32MP157x-DK2 - what's next (1 P)

## Pages in category "STM32MP157x-DK2"

This category contains only the following page.

- [Getting started/STM32MP1 boards/STM32MP157x-DK2](#)  
Stable: 07.09.2020 - 13:42 / Revision: 07.09.2020 - 13:36

A quality version of this page, approved on 7 September 2020, was based off this revision.

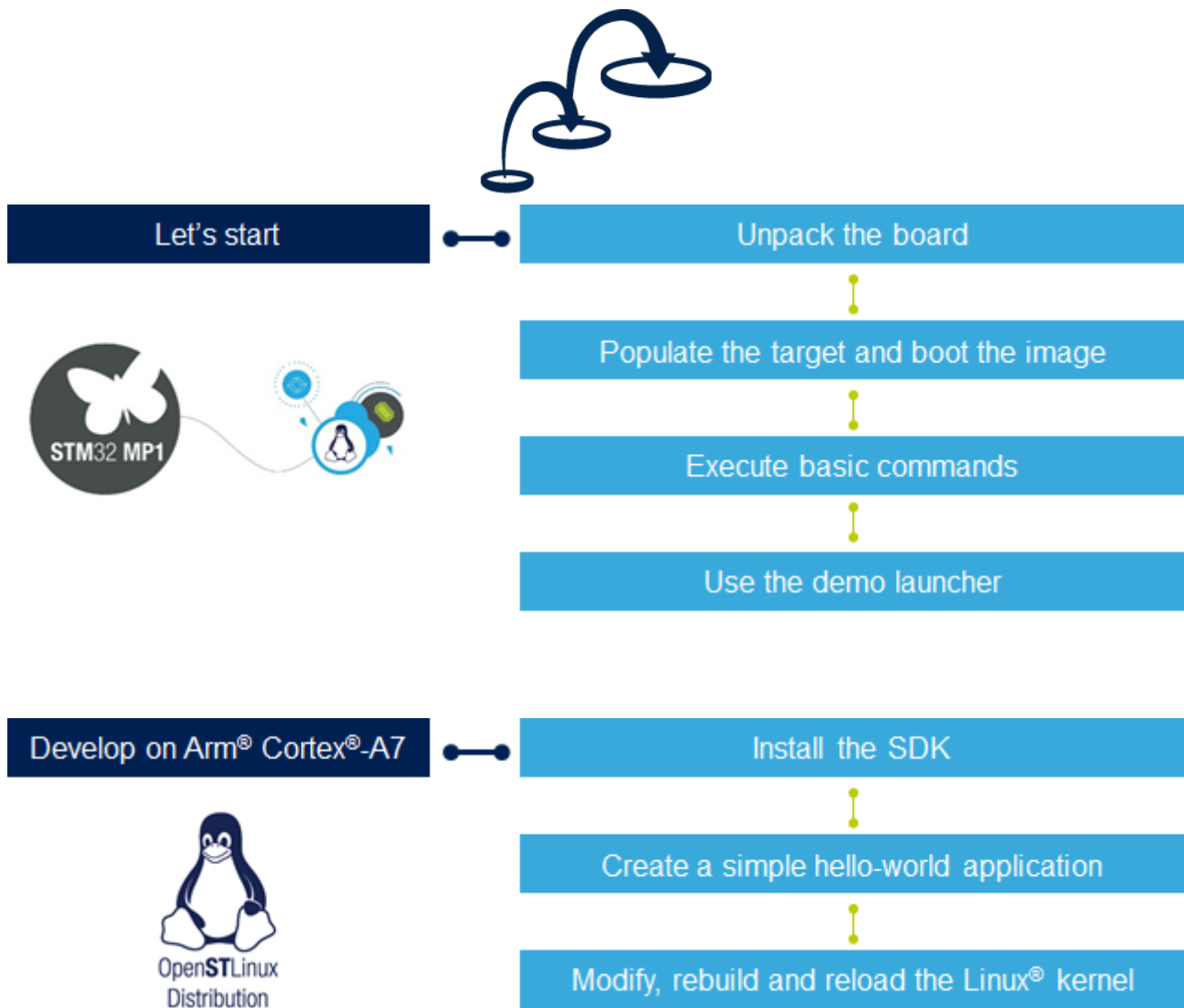



Develop on Arm® Cortex®-M4



Install the IDE

Install the STM32Cube MP1 package

Modify, rebuild and reload a firmware

What's next: Distribution Package and Wiki Development Zone

